

# APEX MONTALTO

## APPLICANT INFORMATION

Name (First, Middle, Last) \_\_\_\_\_  
Current Address \_\_\_\_\_  
City \_\_\_\_\_ State \_\_\_\_\_ Zip code \_\_\_\_\_  
Email address \_\_\_\_\_  
Current Home Phone (\_\_\_\_\_) \_\_\_\_\_ Cell phone (\_\_\_\_\_) \_\_\_\_\_  
Date of Birth (MM/DD/YYYY) \_\_\_\_/\_\_\_\_/\_\_\_\_\_  
Social Security Number \_\_\_\_-\_\_\_\_-\_\_\_\_\_  
Gender (circle one) M or F  
Student athlete (circle one) Y or N What sport? \_\_\_\_\_  
University or College you attend \_\_\_\_\_ Anticipated graduation \_\_\_\_\_  
How did you hear about us? (check one)  
 Website  Drive by/signs  
 Event  Friend/referral (If referred, by whom? \_\_\_\_\_)  
 Newspaper  Other (\_\_\_\_\_)

## APPLICANT HISTORY

Permanent address \_\_\_\_\_  
City \_\_\_\_\_ State \_\_\_\_\_ Zip code \_\_\_\_\_  
Have you ever been evicted from any leased premises? (circle one) Y or N  
If yes, please explain: \_\_\_\_\_  
Have you ever been convicted of a crime? (circle one) Y or N  
If yes, please explain: \_\_\_\_\_  
Have you or your guarantor filed or considered filing for bankruptcy? (circle one) Y or N  
Do you or your guarantor have any liens, judgments, or open court cases? (circle one) Y or N

## LEASING TERMS & NOTICES

Please check one  
 10 month lease  
 12 month lease  Other (\_\_\_\_\_)  
Name of requested roommate(s) (optional): \_\_\_\_\_  
Additional comments or special considerations: \_\_\_\_\_

## APPLICANT SECURITIES

Will a parent or guarantor be paying all of your rent? (circle one) Y or N  
Will you use student loans to pay your rent? (circle one) Y or N  
If yes, have your student loan been approved? (circle one) Y or N  
Please list any grants, scholarships, or education savings to be applied towards housing:  
\_\_\_\_\_  
\_\_\_\_\_

**QUESTIONS? CALL 610-683-8323**

## BEDROOM SELECTION

Please indicate your selection for desired bedroom location within the apartment floor plan.

(Check One Only) Bedroom A: [ ] Bedroom B: [ ] Bedroom C: [ ]

Please Note: Bedroom placement is not guaranteed. Bedrooms are assigned at the discretion of community managers based on apartment occupancy.

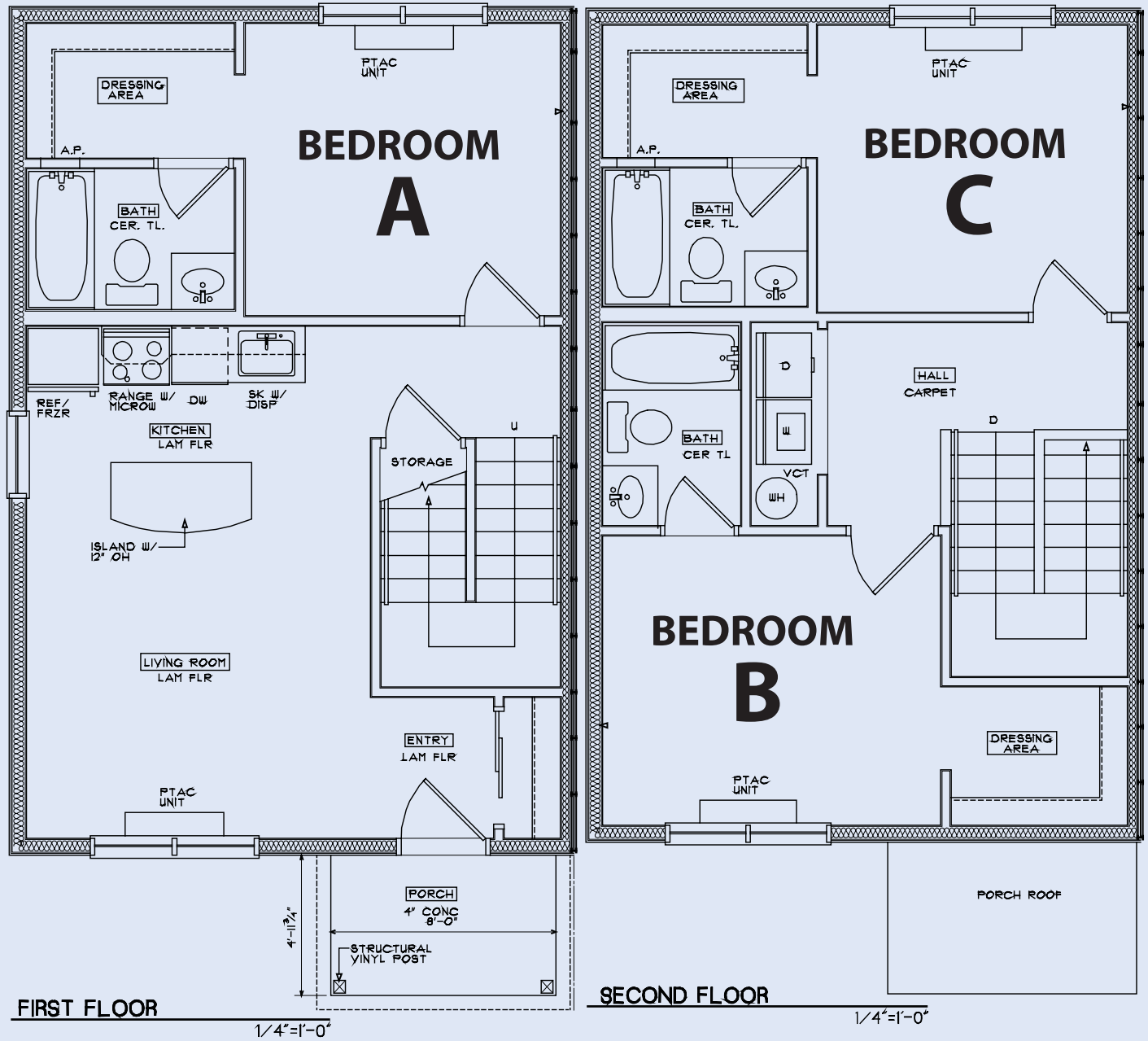

**QUESTIONS? CALL 610-683-8323**

## GUARANTOR/CO-SIGNER INFORMATION

Name (First, Middle, Last) \_\_\_\_\_

Current Address \_\_\_\_\_

City \_\_\_\_\_ State \_\_\_\_\_ Zip code \_\_\_\_\_

Email address \_\_\_\_\_

Current Home Phone (\_\_\_\_\_) \_\_\_\_\_ Cell phone (\_\_\_\_\_) \_\_\_\_\_

Guarantor/Co-signer Social Security Number \_\_\_\_-\_\_\_\_-\_\_\_\_\_

Guarantor's Employer \_\_\_\_\_

Annual Salary \$ \_\_\_\_\_

Number of years at current employer \_\_\_\_\_

Former employer (if under one year)

By signing below, you are agreeing to the following and swear that the above information is correct

Applicant \_\_\_\_\_ Date \_\_\_\_\_

Guarantor \_\_\_\_\_ Date \_\_\_\_\_

By executing this application, I hereby authorize APEX Housing Group to verify all information contained on this application, and to conduct a full background check, including criminal background checks.

It is the policy of this property to reject applicants for any of the following criminal related reasons that have occurred within the ten (10) year period prior to Application Date and up to Occupancy Date regardless of whether or not jail time was served or adjudication was withheld:

- (a) Felony conviction,
- (b) Misdemeanor conviction involving crimes against persons or property,
- (c) Any drug related conviction,
- (d) Any prostitution conviction,
- (e) Any sex related conviction,
- (f) Any terrorist related conviction,
- (g) Any cruelty to animals related conviction
- (h) Any of the above related charges resulting in "adjudication withheld", and
- (i) Active status on probation or parole resulting from any of the above.

Manager and Owner have no duty and are not promising to verify the accuracy of the information provided in response to this application. Furthermore, the Management and Owner have no duty and do not promise to run a criminal background check on every person that applies for occupancy. The ability of Manager and Owner to conduct a criminal background check does not constitute any guarantee that all residents have no prior criminal record or background. The Applicant who signs below states that the information provided is true and correct, and authorizes Manager or Owner to verify this information. Applicant understands that the Manager and Owner are relying on all information in this application. The Manager and/or Owner may cancel any lease entered into if the Applicant has made any misleading, incorrect or untrue statements in this Application.

Applicant certifies to have received, read, understood and further agrees to abide by the Community Guidelines of APEX Housing Group. Applicant may, in writing, cancel the Lease within 72 Hours after the Date of the Application.

**YOU MUST HAVE A GUARANTOR TO COMPLETE THIS APPLICATION. PLEASE INCLUDE THE INFORMATION ABOVE. A CREDIT CHECK WILL BE PERFORMED ON YOUR GUARANTOR INFORMATION.**

TITLE VIII of the CIVIL RIGHT ACT OF 1996 and subsequent amendments make discrimination based on race, color, religion, sex, familial status or national origin illegal in connection with the rental of most housing. The Federal Agency which administers compliance with this law concerning this company: Department of Housing and Urban Development.

EQUAL CREDIT OPPORTUNITY ACT The Federal Equal Credit Opportunity Act prohibits creditors from discriminating against credit applicants on the basis of sex or marital status. The Federal Agency which administers compliance with this law concerning this company: Equal Credit Opportunity, Federal Trade Commission, Washington, DC 20580.

**All information is transmitted over a secure connection.**

**We value your privacy and refuse to share your information with any third-party excluding the credit report.**

**QUESTIONS? CALL 610-683-8323**